



AMERICAN
BROACH & MACHINE CO.

TT-SP

Table Top SP Broaching Machine

Small – Quiet – Simple – Efficient – Electromechanical



Model TT-SP 6-24



Table Top Broaching Machine
w/Detent Auto Retriever
(Automatic Broach Tool Handling)

Perfect for Keyways, Internal Splines, or Forms

Model TT-SP 2-24

Broaching Solutions Since 1919



The President's "E" Award
For Excellence In Exporting



Sizes From 2 - 6 Ton, 24 - 36 Inch Stroke
Cleverly Engineered, with the latest technology.



Engineered Machine Construction – Low Cost, Fast, Simple Operation

This is a plug and play machine, designed for fast simple operator setup and changeover. At less than 2000 lbs, the machine is easy to relocate, and requires no special foundation, pit, or operator stand. This is the perfect cell machine.



Model TT SP 2-24



Table Top "Special" w/ Detent Retriever Unit

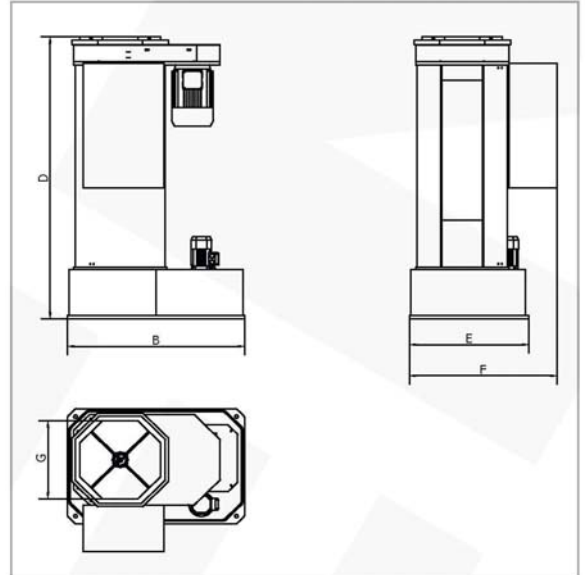

Model (subject to minor changes)		Model TT SP 2-24	Model TT SP 6-24	Model TT SP 6-36
Broaching Force		2 Tons	6 Tons	6 Tons
Stroke Length	A	24 Inch	24 Inch	36 Inch
Foot Print	B x E	38" X 44"	38" X 44"	38" X 44"
Integrated Step		8"	8"	24"
Table Top Size	G	20" X 20"	20" X 20"	20" X 20"
Total Height	D	40 Inches	40 Inches	52 Inches
Weight		1600 Lbs	1630 Lbs	1750 Lbs
Broaching Speed		5-30 Feet/Minute	5-30 Feet/Minute	5-30 Feet/Minute



Standard Pullers for Simple Operation

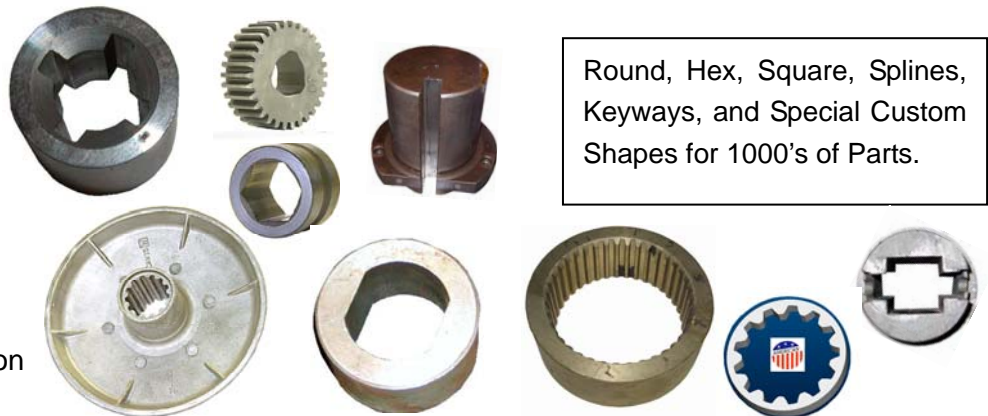

Round, Hex, Square, Splines, Keyways, and Special Custom Shapes for 1000's of Parts.



AMERICAN
BROACH & MACHINE CO.

575 South Mansfield Street
Ypsilanti, Michigan, 48197 USA

Ph # (734) 961-0300

www.americanbroach.com

Engineered Quality Guaranteed for Over 90 Years

- Broaching Machines
- Broach Cutting Tools
- Broach Tooling & Fixtures
- Startup & Runoff Production Broaching Services
- World Famous CNC Broach Grinding / Sharpening Machines